

# DIAGONAL SINK BASE

## *Assembly Tools & Materials Required:*

- Air compressor
- Air hose
- Brad nail gun
- 1/4" inch brad nails
- Drill
- Rubber mallet
- Utility knife
- Wood glue (optional)

## *Assembly techniques used are applicable to:*

- SBD36 & SBD45

## *Instructions: Cabinet Box Assembly*

1. On a flat, smooth work surface lay the face frame down, dado groove side up, and apply a thin strip of wood glue in each pre-cut dado groove of the cabinet frame (optional).

2. Before the glue dries, slide the front side panels into the dado grooves of the frame, pushing upwards to evenly distribute the wood glue. Make sure that both side panels has all pre-cut dado grooves facing inwards towards each other with the smooth finished sides of the side panels facing outwards. Secure the two pieces together using a 135 degree metal bracket, placing one bracket at the top and one at the bottom of the frame. Repeat the same steps to attach the other front side panel.

***Assembly Tip: \*\*If the panels are not sliding into the dado grooves smoothly, you can use a utility knife to carefully trim down the butt cut end on the panels and the dado groove on the frame if there's any unevenness\*\****

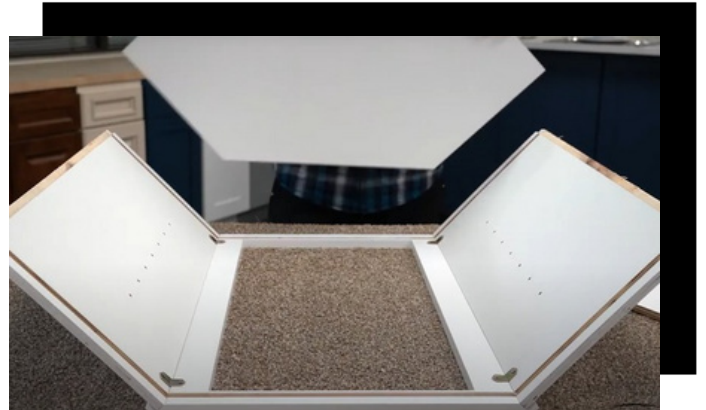

3. Next, place in the bottom panels following the groove lines.

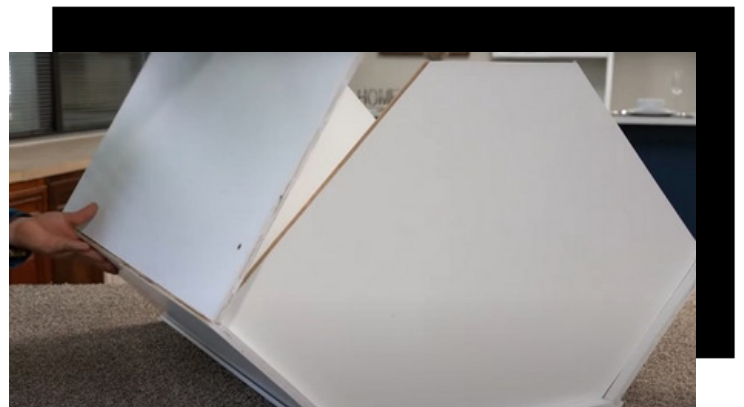
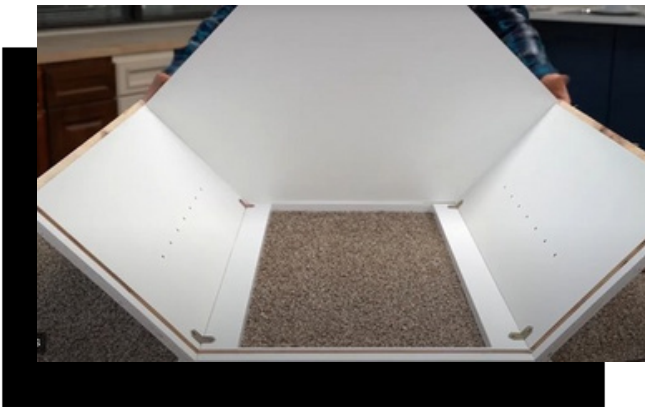

4. Place in one of the remaining rear side panel pieces and screw it in place, using the pre-drilled holes as a guide. Repeat the same for the other rear side panel.

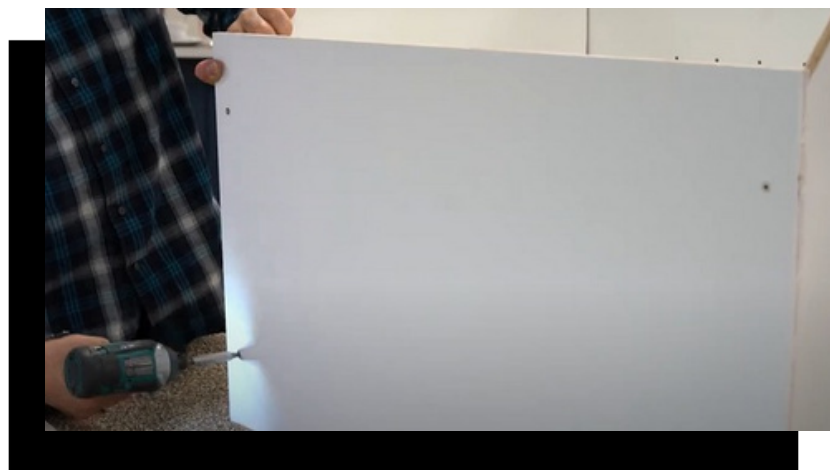

# DIAGONAL SINK BASE

*Instructions: Cabinet Box Assembly cont.*

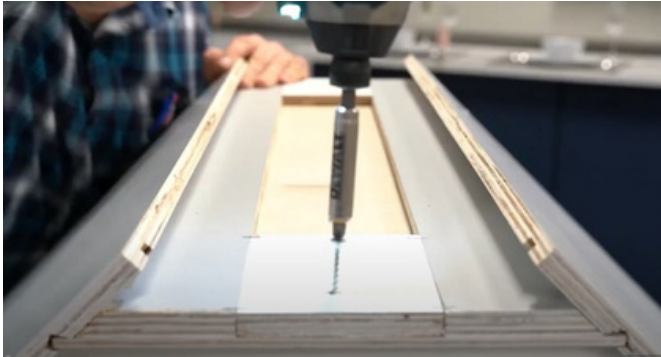

5. Next, place on the back panel piece. Make sure that all the panel pieces are fitted to each other's grooves before securing the pieces together with screws, using the pre-drilled holes as a guide. Reinforce the back panel by screwing on the two included plywood inserts.

6. Screw on the top wooden corner anchoring brackets to secure the final shape of the cabinet box.

7. Finally, complete your cabinet box by placing the toe kick board at the bottom indented edge and screw or nail in place with brad nails.

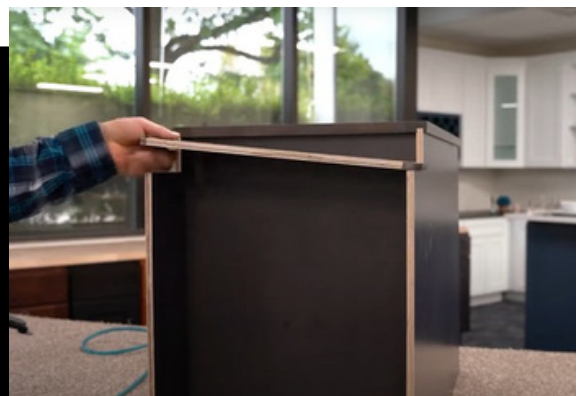

## *Instructions: Door Attachment*



8. Place the hinge into the pre-drilled hinge holes and screw in place. Make sure that you are using the round-headed, short screws and not the flat-headed screws so that the screw won't run through the door. Repeat the same steps for installing the other remaining hinges



9. Align the hinge to the pre-drilled holes on the frame and screw in place.

10. For finishing touches, stick on the rubber door stoppers in the outer back corners of the door.

*Door Adjustment Tip: \*\*If you notice a gap or miss alignment after screwing on the door, you can re-adjust the screws using a screwdriver in order to level and align your door. Be sure that a screwdriver, and not a drill, is used for adjustments since the hinge hardware is really delicate. The front screws adjust the door left and right, and the two side screws adjust the door to move up and down, and inward or outward.*

